

## DRILLS AND ATTACHMENTS

Research and practical application in restricted-area drilling have enabled ATI to design and manufacture the power transmission tools shown in this section. These units have been engineered to perform a multitude of close-quarter drilling operations at low-cost, with emphasis on durability and trouble-free service.

Included are 45°, 90°, 180°, and 360° adjustable models. These angle drills are available in direct drive and flexible drive, with integral chuck or a variety of threaded spindle sizes. To guarantee excellent service, the precision-ground drive shafts and spindles are made of heat-treated tool steel, and revolve on ball and oilite-type bearings.



## DRILL ATTACHMENTS AND DRILLING ACCESSORIES

### ANGLE DRILL ATTACHMENTS

- Used for drilling holes in tight access areas
- Heavy duty gears and bearings
- 1/4" shank for easy connection to drill motors
- Rated for 4500 RPM

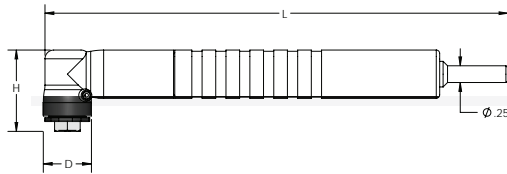

ATI303B

Part Number	Type	Duty	Output Spindle	Drill Capacity	Length	Head Height	Head Diameter
ATI300B	90° Direct Drive	STANDARD	1/4"-28	5/16	6.00	1.625	0.813
ATI301B	45° Direct Drive	STANDARD	1/4"-28	5/16	6.69	1.000	0.813
ATI302B	90° Flex Drive	STANDARD	1/4"-28	5/16	30.00	1.625	0.813
ATI303B	45° Flex Drive	STANDARD	1/4"-28	5/16	30.00	1.000	0.813
ATI326A	90° Direct Drive	LIGHT	10-32	3/16	6.88	0.813	0.500
ATI327A18	90° Flex Drive	LIGHT	10-32	3/16	18.00	0.813	0.500
ATI327A-24	90° Flex Drive	LIGHT	10-32	3/16	24.00	0.813	0.500
ATI326B	90° Direct Drive	LIGHT	1/4"-28	3/16	6.88	0.813	0.500
ATI327B-12	90° Flex Drive	LIGHT	1/4"-28	3/16	12.00	0.813	0.500
ATI327B18	90° Flex Drive	LIGHT	1/4"-28	3/16	18.00	0.813	0.500
ATI327B-24	90° Flex Drive	LIGHT	1/4"-28	3/16	24.00	0.813	0.500
ATI336A	90° Direct Drive	HEAVY	CHUCK	1/4	6.25	1.438	1.000
ATI338A	90° Flex Drive	HEAVY	CHUCK	1/4	30.00	1.438	1.000
ATI336B	90° Direct Drive	HEAVY	1/4"-28	1/4	6.25	1.438	1.000
ATI338B	90° Flex Drive	HEAVY	1/4"-28	1/4	30.00	1.438	1.000
ATI337A	360° Direct Drive	HEAVY	CHUCK	1/4	6.00	1.438	1.000
ATI339A	360° Flex Drive	HEAVY	CHUCK	1/4	30.00	1.438	1.000
ATI337B	360° Direct Drive	HEAVY	1/4"-28	1/4	6.00	1.438	1.000
ATI339B	360° Flex Drive	HEAVY	1/4"-28	1/4	30.00	1.438	1.000

ATI326B

ATI336A

ATI337B

### OFFSET DRILL ATTACHMENTS

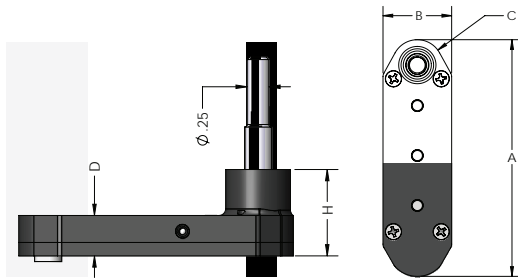

- Offset drive enables drilling in tight access areas
- 1/4" round shank

Part Number	Type	Speed	Spindle	Height (H)	Length (A)	Width (B)	Thickness (D)	Radius C
ATI313A	Straight Offset	6000	10-32	4.31	4.35	0.875	0.290	0.42
ATI313B	Straight Offset	6000	1/4"-28	4.31	4.35	0.875	0.290	0.42
ATI313LA	30° Left Hand Offset	6000	10-32	4.31	4.00	0.875	0.290	0.42
ATI313LB	30° Left Hand Offset	6000	1/4"-28	4.31	4.00	0.875	0.290	0.42
ATI313RA	30° Right Hand Offset	6000	10-32	4.31	4.00	0.875	0.290	0.42
ATI313RB	30° Right Hand Offset	6000	1/4"-28	4.31	4.00	0.875	0.290	0.42
ATI331A	Straight Offset	6000	10-32	4.38	4.19	0.921	0.438	0.44
ATI331B	Straight Offset	6000	1/4"-28	4.38	4.19	0.921	0.438	0.44
ATI332A	Straight Offset	4200	10-32	1.50	3.17	0.920	0.370	0.34
ATI332B	Straight Offset	4200	1/4"-28	1.50	3.17	0.920	0.370	0.34
ATI332SC	Straight Offset	4200	1/4"-28	1.50	3.12	0.920	0.320	0.31
ATI333B	Straight Offset, Reversed	4200	1/4"-28	1.50	3.18	0.960	0.500	0.32

ATI313LB

ATI331B



**SAFETY PRECAUTION:** Read and follow all safety and operating instructions.  
**WARNING:** Face & eye protection must be worn while operating power tools, per ANSI B186.1

## DRILL ATTACHMENTS AND DRILLING ACCESSORIES

### DRILL GUIDE HOUSINGS

- Maintains tool perpendicular to flat or curved surfaces
- Used with drills, taps or reamers
- Case-hardened bushings are interchangeable in housings
- Housings provide ample relief for chips under the bushing
- Guide assemblies consist of housing with bushing installed
- Threaded interface allows interchangeability of bushings and housings

ATI589AA

STANDARD SLIP RENEWABLE  
DRILL BUSHING  
\*Not available  
from ATI

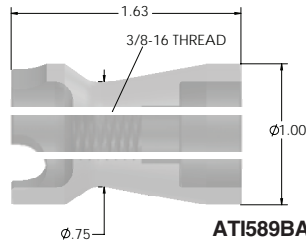
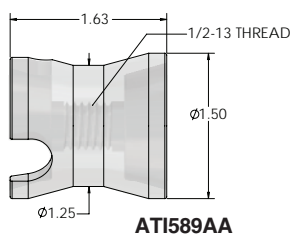

ATI589CA

ATI589CAM

### DRILL GUIDE HOUSINGS

Housing Part Number	Description	Bushing Reference
ATI589AA	THREADED DRILL GUIDE HOUSING DRILL SIZES #40 (.098) THRU 5/16" (.3125)	ATI589AB-series 1/2"-13
ATI589BA	THREADED DRILL GUIDE HOUSING DRILL SIZES #40 (.098) THRU 1/4"	ATI58924T-series 3/8"-16
ATI589CA	THREADED DRILL GUIDE HOUSING LARGER DIAMETER FOR EASE IN BUSHING EXCHANGE DRILL SIZES 1/4" (.250) THRU 9/16" (.5625)	ATI589CB-series 3/4"-16
ATI589CAM	THREADED DRILL GUIDE HOUSING DRILL SIZES 1/4" (.250) THRU 9/16" (.5625)	ATI589CB-series 3/4"-16
ATI589DA	FLANGE LOCK DRILL GUIDE HOUSING DRILL SIZES #80 (.0135) THRU #10 (.1935)	*SLIP RENEWABLE 5/16" OD X 3/4" LONG
ATI589EA	FLANGE LOCK DRILL GUIDE HOUSING DRILL SIZES #28 (.1405) THRU 11/32" (.3438)	*SLIP RENEWABLE 1/2" OD X 3/4" LONG

### DRILL BUSHING ASSEMBLY KIT

#### ATI590DBK

These unique hand-held guides keep drills and taps perpendicular to the skin surface. The interchangeable bushings are hardened to provide maximum wear and extended life. The kit consists of three plastic housings and nine bushings.

Kit includes:

3	ATI589AA	1	ATI589AB1875
1	ATI589AB098	1	ATI589AB1935
1	ATI589AB1285	1	ATI589AB2187
1	ATI589AB1562	1	ATI589AB250
1	ATI589AB159	1	ATI589AB-257



Drill Guide Assemblies Part Number	Drill Bushing Part Number	Drill Size	Bushing Size
ATI589A-3T098	ATI58924T098	#40	3/8"-16
ATI589A-3T125	ATI58924T125	1/8"	3/8"-16
ATI589A-3T128	ATI58924T128	#30	3/8"-16
ATI589A-3T156	ATI58924T156	5/32"	3/8"-16
ATI589A-3T159	ATI58924T159	#21	3/8"-16
ATI589A-3T161	ATI58924T161	#20	3/8"-16
ATI589A-3T177	ATI58924T177	#16	3/8"-16
ATI589A-3T187	ATI58924T187	3/16"	3/8"-16
ATI589A-3T193	ATI58924T193	#10	3/8"-16
ATI589A-3T234	ATI58924T234	15/64"	3/8"-16
ATI589A-3T250	ATI58924T250	1/4 or E	3/8"-16

\*Special drill bushing sizes available upon request

**Drill Guide Assembly**

Drill Guide Assemblies Part Number	Drill Bushing Part Number	Drill Size	Bushing Size
ATI589A-093	ATI589AB093	3/32	1/2"-13
ATI589A-098	ATI589AB098	#40	1/2"-13
ATI589A-125	ATI589AB125	1/8	1/2"-13
ATI589A-1285	ATI589AB1285	#30	1/2"-13
ATI589A-1562	ATI589AB1562	5/32	1/2"-13
ATI589A-159	ATI589AB159	#21	1/2"-13
ATI589A161	ATI589AB-161	#20	1/2"-13
ATI589A166	ATI589AB-166	#19	1/2"-13
ATI589A173	ATI589AB-173	#17	1/2"-13
ATI589A177	ATI589AB-177	#16	1/2"-13
ATI589A185	ATI589AB1850	#13	1/2"-13
ATI589A-1875	ATI589AB1875	3/16	1/2"-13
ATI589A189	ATI589AB1890	#12	1/2"-13
ATI589A191	ATI589AB191	#11	1/2"-13
ATI589A-1935	ATI589AB1935	#10	1/2"-13
ATI589A-199	ATI589AB-199	#8	1/2"-13
ATI589A2187	ATI589AB2187	7/32	1/2"-13
ATI589A2344	ATI589AB2344	15/64	1/2"-13
ATI589A250	ATI589AB250	1/4 or E	1/2"-13
ATI589A257	ATI589AB-257	F	1/2"-13

\*Special drill bushing sizes available upon request

**Drill Bushing**

Drill Guide Assemblies Part Number	Drill Bushing Part Number	Drill Size	Bushing Size
ATI589C-2812	ATI589CB2812	9/32	3/4"-16
ATI589C.3125	ATI589CB3125	5/16	3/4"-16
ATI589C-3437	ATI589CB3437	11/32	3/4"-16
ATI589C-375	ATI589CB375	3/8	3/4"-16
ATI589C-4375	ATI589CB4375	7/16	3/4"-16
ATI589C-.500	ATI589CB500	1/2	3/4"-16

\*Special drill bushing sizes available upon request



**SAFETY PRECAUTION:** Read and follow all safety and operating instructions.  
**WARNING:** Face & eye protection must be worn while operating power tools, per ANSI B186.1

# DRILL ATTACHMENTS AND DRILLING ACCESSORIES

## STRAP DUPLICATORS

### FEATURES:

- Provides an accurate method for duplicating hidden holes in overlapping sheets
- Standard pilots are used when sheets can be pried apart. Inverted pilots are used when sheets cannot be separated. Spring loaded center punch allows for marking in limited access for drilling later
- Position pilot in hole to be duplicated then drill through bushing. Back side of pilot is relieved to allow drill to pass through first sheet only
- Straps are spring steel. Bushings, pilots and center punch are hardened drill rod assuring accurate hole duplication. Tools are identified with part number and drill size
- Working length is shown, maximum distance from edge of sheet to hole. Back side of strap is beveled to aid in prying sheets apart

### ATI532-61

6-1/4" Length Part Number	13-1/4" Length Part Number	Type	Drill Size
ATI532-61	ATI532C-61	Bushing, Standard Pilot	#40
ATI532-62	ATI532C-62	Bushing, Standard Pilot	#30
ATI532-63	ATI532C-63	Bushing, Standard Pilot	#21
ATI532-64	ATI532C-64	Bushing, Standard Pilot	#19
ATI532-65	ATI532C-65	Bushing, Standard Pilot	#10
ATI532-66	ATI532C-66	Bushing, Standard Pilot	#5
ATI532-67	ATI532C-67	Bushing, Standard Pilot	F
ATI532-68	ATI532C-68	Bushing, Standard Pilot	1/4"

\*Special bushing and pilot sizes available upon request

### ATI500-52

6-1/4" Length Part Number	13-1/4" Length Part Number	Type	Drill Size
ATI500-51	ATI500C-51	Spring Loaded Center Punch	#40
ATI500-52	ATI500C-52	Spring Loaded Center Punch	#30
ATI500-53	ATI500C-53	Spring Loaded Center Punch	#21
ATI500-54	ATI500C-54	Spring Loaded Center Punch	#19
ATI500-55	ATI500C-55	Spring Loaded Center Punch	#10
ATI500-56	ATI500C-56	Spring Loaded Center Punch	#5
ATI500-57	ATI500C-57	Spring Loaded Center Punch	F
ATI500-58	ATI500C-58	Spring Loaded Center Punch	1/4"

\*Special bushing and pilot sizes available upon request

### ATI532A-61

6-1/4" Length Part Number	13-1/4" Length Part Number	Type	Drill Size
ATI532A-61	ATI532D-61	Bushing, Inverted Pilot	#40
ATI532A-62	ATI532D-62	Bushing, Inverted Pilot	#30
ATI532A-63	ATI532D-63	Bushing, Inverted Pilot	#21
ATI532A-64	ATI532D-64	Bushing, Inverted Pilot	#19
ATI532A-65	ATI532D-65	Bushing, Inverted Pilot	#10
ATI532A-66	ATI532D-66	Bushing, Inverted Pilot	#5
ATI532A-67	ATI532D-67	Bushing, Inverted Pilot	F
ATI532A-68	ATI532D-68	Bushing, Inverted Pilot	1/4"

\*Special bushing and pilot sizes available upon request

### STRAP DUPLICATORS SETS

ATI532A/SET	10 PIECE SET STANDARD & INVERTED PILOT	Includes Items in Blue
-------------	--	------------------------



**THREADED SHANK 3-JAW CHUCK**

**ATI339EC**

- Drill bit capacity from 1/16" to 1/4"
- Allows use of standard straight shank drills in tools with threaded spindles
- Internal jaws are inverted for maximum chucking torque
- 1/4"-28 threaded shank

**ATI339EC**

**THREADED SHANK DRILL ADAPTORS**

- Enables use of straight shank drill bits with threaded output angle drill attachments
- Retains drill bit with set screw
- 1/4"-28 threaded shank

**THREADED SHANK DRILL COLLETS**

- Enables use of straight shank drill bits with threaded output angle drill attachments
- 1/4"-28 threaded shank

1/4-28

5

**ATI503-40**

**ATI503-72**

Part Number	Drill Size
ATI503-40	#40
ATI503-30	#30
ATI503-21	#21
ATI503-20	#20
ATI503-11	#11
ATI503-10	#10
ATI503-3	#3
ATI503-66	1/8
ATI503-70	3/16
ATI503-72	1/4
ATI503-73	5/16
ATI503-74	3/8
ATI503-77	F
ATI503-78	N

**ATI503C-1/8**

Part Number	Drill Size
ATI503C-3/32	3/32
ATI503C-40	#40
ATI503C-1/8	1/8
ATI503C-30	#30
ATI503C-5/32	5/32
ATI503C-21	#21
ATI503C-20	#20
ATI503C-19	#19
ATI503C-16	#16
ATI503C-3/16	3/16
ATI503C-12	#12
ATI503C-11	#11
ATI503C-10	#10
ATI503C-7/32	7/32
ATI503C-1/4	1/4
ATI503C-F	F

**QUICK-CHANGE DRILL COLLET**

Part Number	Description
ATI504C-1/4	Colleting Adaptor, Two-Piece, Quick-change shank, 1/4"



**SAFETY PRECAUTION:** Read and follow all safety and operating instructions.  
**WARNING:** Face & eye protection must be worn while operating power tools, per ANSI B186.1

# DRILL ATTACHMENTS AND DRILLING ACCESSORIES

## THREADED DRILLS, DEBURRING TOOLS AND CHIP CHASERS

### THREADED SHANK DRILL BITS

- MADE FROM HSS
- 135° Split Point
- 1/4"-28 threaded shank

Part Number	Drill Size	Length	Type	Part Number	Drill Size	Length	Type
ATIHSSST3/32	3/32	0.50	STUB	ATIHSSL5/32	5/32	2.13	LONG
ATIHSSST40	#40	0.50	STUB	ATIHSSST21	#21	0.56	STUB
ATIHSSSH40	#40	1.00	SHORT	ATIHSSST3/16	3/16	0.56	STUB
ATIHSSST1/8	1/8	0.50	STUB	ATIHSSSH3/16	3/16	1.25	SHORT
ATIHSSSH1/8	1/8	1.00	SHORT	ATIHSSL3/16	3/16	2.13	LONG
ATIHSSL1/8	1/8	2.13	LONG	ATIHSSST10	#10	0.56	LONG
ATIHSSST30	#30	0.56	STUB	ATIHSSH10	#10	1.25	SHORT
ATIHSSH30	#30	1.25	SHORT	ATIHSSST1/4	1/4	0.63	STUB
ATIHSSL30	#30	2.13	LONG	ATIHSSSH1/4	1/4	1.25	SHORT
ATIHSSST5/32	5/32	0.56	STUB	ATIHSSL1/4	1/4	2.13	LONG
ATIHSSSH5/32	5/32	1.25	SHORT				

### SPEED DRIVER, DEBURRING TOOLS AND CUTTERS

'Speed Driver' an ATI original, with swivel handle and unique offset shaft allows for rapid, uniform and safe deburring of drilled holes.

Part Number	Description
ATI521A	SPEED DRIVER, used with ATI521C deburring cutter. Tool has a taper lock spindle and only accepts this cutter
ATI521B	SPEED DRIVER, used with ATI407-4 deburr/countersink cutter. Accepts any 1/4"-28 threaded shank cutters
ATI521C	DEBURRING CUTTER, 100-degree cutting angle, 3-flute, 3/8 body, 7/32 shank diameter
ATI407-4	COUNTERSINK CUTTER, 100-degree cutting angle, 3-flute, 3/8" body, 1/4"-28 threaded shank. Can be used in any drill attachment that accepts 1/4"-28 threaded shank cutters

ATI521A

ATI521C

ATI407-4

### CARBIDE DEBURRING BLADE

#### ATI437C SERIES

Used in conjunction with squaring and deburring heads, these blades perform on hydraulic tubing ends. Available in sets of 3 or individually. A set includes one outside, one inside, and one squaring blade.

3 Piece Kit	Square Blade	Inside Blade	Outside Blade
ATI437C	ATI437C-1	ATI437C-2	ATI437C-3

ATI437C

### CHIP CHASERS

Designed to remove chips that accumulate between sheet stock after drilling rivet holes. Handles are cast aluminum and the blades are made from clock spring steel.

#### CHIP CHASERS WITH INTERCHANGEABLE BLADES

Chip Chaser Assembly Part Number	Chip Chaser Blade Part Number	Blade Length	Hook Style
ATISP200-1	ATISP20002	5-7/8"	Pointed
ATISP200-2	ATISP20003	5-7/8"	Blunt
ATISP200-3	ATISP20004	2-3/4"	Pointed
ATISP200-4	ATISP20005	2-3/4"	Blunt
ATISP200	Chip Chaser Handle		

ATISP200-1

#### CHIP CHASERS WITH MOLDED HANDLES

Chip Chaser Part Number	Blade Length	Hook Style
ATI511	2-3/4"	Pointed
ATI512	5-7/8"	Pointed

ATI512



### EDGE BREAKERS

Quickly removes burrs & sharp edges from sheet stock.

Part Number	Description
ATI514	Hardened tip, safety shield and plastic handle works well on aluminum sheet stock

ATI514

### BURNISHING TOOL - ATI515

Designed to remove blemishes in materials. Heat-treated blade is chrome-plated, polished to mirror finish, and 2-3/8" long. Large plastic safety handle insures comfortable grip.

Part Number	Description
ATI515	Burnishing Tool, Hard chrome plated, 2-3/8" blade length, plastic handle

ATI515

## DUPLICATING PUNCHES

- Accurately duplicate hole location from one sheet to another.
- Heat-treated, the locating diameter and punch are ground to insure absolute concentricity and held to close tolerances

Part Number	D	L
ATI507-1	3/32	1/4
ATI507-2	#40	1/4
ATI507-3	1/8	3/8
ATI507-4	#30	3/8
ATI507-5	5/32	1/2
ATI507-6	#19	1/2
ATI507-7	3/16	1/2
ATI507-8	#10	1/2
ATI507-9	7/32	1/2
ATI507-10	1/4	1/2
ATI507-11	5/16	1/2
ATI507-12	3/8	1/2
ATI507-13	7/16	1/2
ATI507-14	1/2	1/2

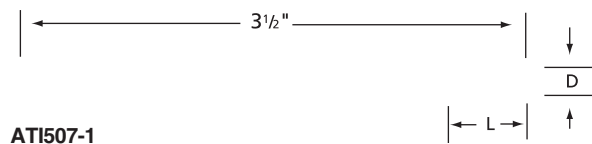

### DUPLICATING PUNCH KIT

#### ATI507KT

Kit contains fourteen 3-1/2" OAL punches, sizes 3/32", #40, 1/8", #30, 5/32", #19, 3/16", #10, 7/32", 1/4", 5/16", 3/8", 7/16", and 1/2".

ATI507KT



**SAFETY PRECAUTION:** Read and follow all safety and operating instructions.  
**WARNING:** Face & eye protection must be worn while operating power tools, per ANSI B186.1

## DRILL ATTACHMENTS AND DRILLING ACCESSORIES

### NUT PLATE DRILL JIGS

- Used for accurate drilling of rivet holes for nut plate fasteners
- Flexible handle provides clearance for hand during use
- Hardened steel head for durability

#### ONE LUG — SINGLE WING STANDARD (SWS)

Part Number	Type	"A" Spacing	"C" Pilot Diameter	"D" Drill Size
ATI518G	SWS	.344	.139	#40
ATI518H	SWS	.344	.164	#40
ATI518RL	SWS	.344	.165	#40
ATI518RC	SWS	.344	.168	#40
ATI518RM	SWS	.344	.188	#40
ATI518J	SWS	.344	.191	#40
ATI518RD	SWS	.344	.192	#40
ATI518L	SWS	.344	.213	#40
ATI518RU	SWS	.344	.227	#40
ATI518K	SWS	.344	.248	#40
ATI518RE	SWS	.344	.256	#40
ATI518LF	SWS	.344	.281	#40
ATI518RW	SWS	.344	.311	#40
ATI518RO	SWS	.500	.248	#40
ATI518RF	SWS	.500	.256	#40
ATI518RX	SWS	.500	.311	#40
ATI518YF	SWS	.500	.343	#40
ATI518RP	SWS	.500	.311	#30
ATI518RG	SWS	.500	.315	#30
ATI518FH	SWS	.500	.372	#30
ATI518RH	SWS	.500	.373	#30
ATI518RJ	SWS	.562	.435	#30
ATI518RB	SWS	.344	.143	#40

ATI518J

»» ORDER SPECIAL ONE-LUG, SINGLE-WING STANDARD, DRILL JIG'S AS FOLLOWS:



#### ONE LUG — SINGLE WING MINIATURE (SWM)

Part Number	Type	"A" Spacing	"C" Pilot Diameter	"D" Drill Size
ATI518NASBA2	SWM	.125	.086	#51
ATI518NASBA3	SWM	.133	.099	#51
ATI518NASBA4	SWM	.148	.112	#51
ATI518NASBA6	SWM	.171	.139	#51
ATI518PA	SWM	.203	.112	#40
ATI518JA	SWM	.203	.140	#40
ATI518PB	SWM	.218	.139	#40
ATI518JB	SWM	.218	.166	#40
ATI518PC	SWM	.234	.164	#40
ATI518JC	SWM	.234	.193	#40
ATI518PD	SWM	.250	.191	#40
ATI518JD	SWM	.250	.218	#40
ATI518PE	SWM	.281	.248	#40
ATI518JE	SWM	.281	.281	#40
ATI518PF	SWM	.250	.188	#40

ATI518PB

»» ORDER SPECIAL ONE-LUG, SINGLE-WING MINIATURE, DRILL JIG'S AS FOLLOWS:



AT1518C

TWO LUG — DOUBLE WING STANDARD (DWS)

Part Number	Type	"A" Spacing	"B" Spacing	"C" Pilot Diameter	"D" Drill Size
AT1518A	DWS	.344	.688	.139	#40
AT1518B	DWS	.344	.688	.164	#40
AT1518KK	DWS	.344	.688	.165	#40
AT1518KC	DWS	.344	.688	.168	#40
AT1518KL	DWS	.344	.688	.188	#40
AT1518C	DWS	.344	.688	.191	#40
AT1518KD	DWS	.344	.688	.192	#40
AT1518KT	DWS	.344	.688	.227	#40
AT1518KU	DWS	.344	.688	.256	#40
AT1518BF	DWS	.344	.688	.281	#40
AT1518HL	DWS	.344	.688	.290	#40
AT1518GM	DWS	.344	.688	.312	#40
AT1518HE	DWS	.3125	.625	.187	#40
AT1518HM	DWS	.3125	.625	.218	#40
AT1518HO	DWS	.375	.750	.248	#40
AT1518HP	DWS	.375	.750	.281	#40
AT1518HH	DWS	.375	.750	.372	#40
AT1518M	DWS	.375	.750	.438	#40
AT1518HN	DWS	.375	.750	.467	#40
AT1518GT	DWS	.4375	.875	.373	#40
AT1518HX	DWS	.450	.900	.372	#40
AT1518D	DWS	.500	1.000	.248	#40
AT1518KE	DWS	.500	1.000	.256	#40
AT1518GR	DWS	.500	1.000	.271	#40
AT1518GS	DWS	.500	1.000	.296	#40
AT1518KV	DWS	.500	1.000	.311	#40
AT1518DF	DWS	.500	1.000	.343	#40
AT1518GG	DWS	.500	1.000	.656	#40
AT1518GL	DWS	.344	.688	.218	#40
AT1518KA	DWS	.344	.688	.119	#40
AT1518KB	DWS	.344	.688	.143	#40
AT1518HF	DWS	.500	1.000	.191	#30
AT1518HJ	DWS	.500	1.000	.248	#30
AT1518KN	DWS	.500	1.000	.311	#30
AT1518E	DWS	.500	1.000	.312	#30
AT1518KF	DWS	.500	1.000	.315	#30
AT1518F	DWS	.500	1.000	.372	#30
AT1518KG	DWS	.500	1.000	.373	#30
AT1518GD	DWS	.500	1.000	.375	#30
AT1518HG	DWS	.500	1.000	.389	#30
AT1518HD	DWS	.500	1.000	.500	#30

»» ORDER SPECIAL TWO-LUG, DOUBLE-WING STANDARD, DRILL JIG'S AS FOLLOWS:

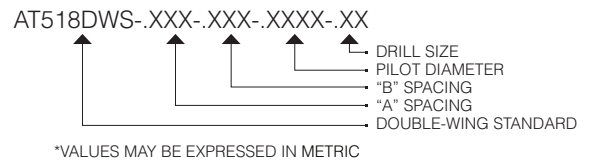

Part Number	Type	"A" Spacing	"B" Spacing	"C" Pilot Diameter	"D" Drill Size
AT1518HS	DWS	.500	1.000	.561	#30
AT1518GB	DWS	.500	1.000	.593	#30
AT1518HT	DWS	.500	1.000	.624	#30
AT1518N	DWS	.500	1.000	.688	#30
AT1518GA	DWS	.500	1.000	.702	#30
AT1518GP	DWS	.562	1.124	.438	#30
AT1518HW	DWS	.592	1.184	.811	#30
AT1518GN	DWS	.595	1.190	.592	#30
AT1518KH	DWS	.625	1.250	.435	#30
AT1518HB	DWS	.687	1.375	.191	#30
AT1518HC	DWS	.687	1.375	.405	#30
AT1518KJ	DWS	.687	1.375	.498	#30
AT1518GE	DWS	.687	1.375	.500	#30
AT1518HK	DWS	.687	1.375	.656	#30
AT1518GC	DWS	.687	1.375	.718	#30
AT1518HA	DWS	.687	1.375	.749	#30
AT1518P	DWS	.687	1.375	.811	#30
AT1518HY	DWS	.700	1.400	.850	#30
AT1518GK	DWS	.500	1.000	.343	#30
AT1518KP	DWS	.500	1.000	.457	#30
AT1518GF	DWS	.375	.750	.437	#40
AT1518GH	DWS	.375	.750	.397	#40
AT1518GJ	DWS	.500	1.000	.281	#40
AT1518SP1171	DWS	.562	1.124	.191	#40
AT1518NASAA5	DWS	.359	.718	.312	#30
AT1518NASA06	DWS	.414	.828	.372	#30



**SAFETY PRECAUTION:** Read and follow all safety and operating instructions.  
**WARNING:** Face & eye protection must be worn while operating power tools, per ANSI B186.1

# DRILL ATTACHMENTS AND DRILLING ACCESSORIES

## NUT PLATE DRILL JIGS

### TWO LUG — DOUBLE WING MINIATURE (DWM)

Part Number	Type	"A" Spacing	"B" Spacing	"C" Pilot Diameter	"D" Drill Size
ATI518NASAA2	DWM	.125	.250	.086	#51
ATI518NASAA3	DWM	.133	.265	.099	#51
ATI518NASA4	DWM	.148	.296	.112	#51
ATI518NSAA06	DWM	.172	.343	.139	#51
ATI518NA	DWM	.203	.406	.112	#40
ATI518AA	DWM	.203	.406	.140	#40
ATI518BA	DWM	.203	.406	.180	#40
ATI518NB	DWM	.218	.436	.139	#40
ATI518AB	DWM	.219	.437	.166	#40
ATI518BB	DWM	.219	.437	.2055	#40
ATI518NC	DWM	.234	.468	.164	#40
ATI518NG	DWM	.234	.468	.1925	#40
ATI518AC	DWM	.234	.468	.193	#40
ATI518NH	DWM	.234	.468	.227	#40
ATI518BC	DWM	.234	.468	.234	#40
ATI518ND	DWM	.250	.500	.191	#40
ATI518AD	DWM	.250	.500	.218	#40
ATI518BD	DWM	.250	.500	.257	#40
ATI518NE	DWM	.281	.562	.248	#40
ATI518AE	DWM	.281	.562	.281	#40
ATI518BE	DWM	.281	.562	.323	#40
ATI518NF	DWM	.313	.625	.312	#30
ATI518AF	DWM	.313	.625	.343	#30
ATI518ZX	DWM	.539	1.080	.248	#40
ATI518SP1016	DWM	.295	.590	.217	#40
ATI518BG	DWM	.359	.718	.373	#30
ATI518NJ	DWM	.250	.500	.1875	#40

ATI518ND

»» ORDER SPECIAL TWO-LUG, DOUBLE-WING MINIATURE, DRILL JIG'S AS FOLLOWS:

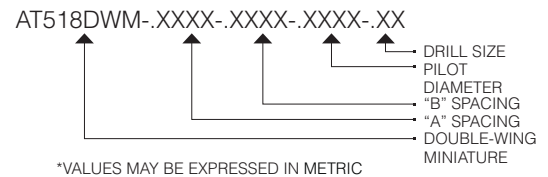

### CORNER WING STANDARD (CWS)

Part Number	Type	"A" Spacing	"C" Pilot Diameter	"D" Drill Size
ATI518R	CWS	.344	.139	#40
ATI518S	CWS	.344	.164	#40
ATI518MK	CWS	.344	.1645	#40
ATI518MC	CWS	.344	.1675	#40
ATI518ML	CWS	.344	.1875	#40
ATI518T	CWS	.344	.191	#40
ATI518MD	CWS	.344	.192	#40
ATI518MT	CWS	.344	.2265	#40
ATI518MU	CWS	.500	.2555	#40
ATI518U	CWS	.500	.248	#40
ATI518ME	CWS	.500	.2555	#40
ATI518MV	CWS	.500	.3105	#40
ATI518MN	CWS	.500	.311	#30
ATI518V	CWS	.500	.312	#30
ATI518MF	CWS	.500	.3145	#30
ATI518W	CWS	.500	.372	#30
ATI518MP	CWS	.500	.373	#30
ATI518MR	CWS	.562	.435	#30
ATI518X	CWS	.562	.4375	#30
ATI518MB	CWS	.344	.1425	#40
ATI518NASCA5	CWS	.358	.312	#30

ATI518U

»» ORDER SPECIAL CORNER-WING STANDARD DRILL JIG'S AS FOLLOWS:

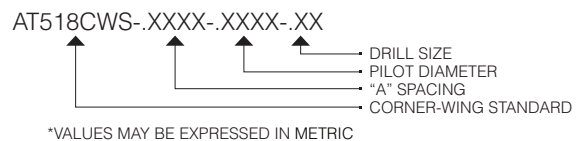

AT1518SD

**CORNER WING MINIATURE (CWM)**

Part Number	Type	"A" Spacing	"C" Pilot Diameter	"D" Drill Size
AT1518NSCA02	CWM	.125	.086	#51
AT1518NSCA03	CWM	.138	.099	#51
AT1518NSCA04	CWM	.148	.112	#51
AT1518NSCA06	CWM	.172	.139	#51
AT1518SA	CWM	.203	.112	#40
AT1518UA	CWM	.203	.140	#40
AT1518SB	CWM	.218	.139	#40
AT1518UB	CWM	.218	.166	#40
AT1518SC	CWM	.234	.164	#40
AT1518UC	CWM	.234	.193	#40
AT1518SD	CWM	.250	.191	#40
AT1518UD	CWM	.250	.218	#40
AT1518SE	CWM	.281	.248	#40
AT1518UE	CWM	.281	.281	#40
AT1518SF	CWM	.312	.312	#30
AT1518UF	CWM	.312	.343	#30
AT1518SJ	CWM	.250	.1875	#40

»» ORDER SPECIAL CORNER-WING MINIATURE DRILL JIG'S AS FOLLOWS"



AT1518TA

**MINIATURE ANCHORNUIT (SLM)**

Part Number	Type	"A" Spacing	"B" Spacing	"C" Pilot Diameter	"D" Drill Size
AT1518NSDA08	SLM	.234	.219	.164	#40
AT1518TA	SLM	.250	.219	.191	#40
AT1518TB	SLM	.281	.219	.248	#40
AT1518TC	SLM	.312	.250	.312	#30
AT1518TD	SLM	.359	.269	.3125	#30
AT1518TE	SLM	.250	.219	.1875	#40
AT1518NASDA5	SLM	.359	.269	.312	#30
AT1518NASDA6	SLM	.414	.269	.372	#30

»» ORDER SPECIAL MINIATURE ANCHORNUIT DRILL JIG'S AS FOLLOWS:

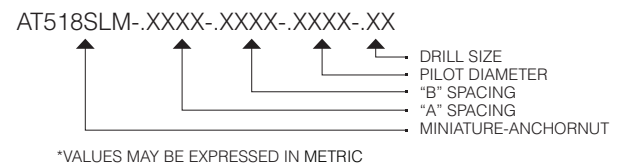

**SAFETY PRECAUTION:** Read and follow all safety and operating instructions.  
**WARNING:** Face & eye protection must be worn while operating power tools, per ANSI B186.1

# DRILL ATTACHMENTS AND DRILLING ACCESSORIES

## NUT PLATE CONVERSIONS

### SINGLE WING

Nutplate Spec	Style	Part Number
MS21051-06	Single Wing	ATI518G
MS21051-08	Single Wing	ATI518H
MS21051-3	Single Wing	ATI518J
MS21051-4	Single Wing	ATI518K
MS21051-5	Single Wing	ATI518RP
MS21051-6	Single Wing	ATI518RH
MS21052-06	Single Wing	ATI518G
MS21052-08	Single Wing	ATI518H
MS21052-3	Single Wing	ATI518J
MS21052-4	Single Wing	ATI518K
MS21052-5	Single Wing	ATI518RP
MS21052-6	Single Wing	ATI518RH
MS21053-08	Single Wing	ATI518H
MS21053-3	Single Wing	ATI518J
MS21053-4	Single Wing	ATI518RO
MS21053-5	Single Wing	ATI518RP
MS21054-08	Single Wing	ATI518H
MS21054-3	Single Wing	ATI518J
MS21054-4	Single Wing	ATI518RO
MS21054-5	Single Wing	ATI518RP
MS21061-06	Single Wing	ATI518G
MS21061-08	Single Wing	ATI518H
MS21061-3	Single Wing	ATI518J
MS21061-4	Single Wing	ATI518RO
MS21061-5	Single Wing	ATI518RP
MS21061-6	Single Wing	ATI518RH
MS21062-06	Single Wing	ATI518G
MS21062-08	Single Wing	ATI518H
MS21062-3	Single Wing	ATI518J
MS21062-4	Single Wing	ATI518RO
MS21062-5	Single Wing	ATI518RP
MS21062-6	Single Wing	ATI518RH
MS21071-04	Single Wing	ATI518PA
MS21071-06	Single Wing	ATI518PB
MS21071-08	Single Wing	ATI518PC
MS21071-3	Single Wing	ATI518PD
MS21071-4	Single Wing	ATI518PE
MS21072-04	Single Wing	ATI518PA
MS21072-06	Single Wing	ATI518PB
MS21072-08	Single Wing	ATI518PC
MS21072-3	Single Wing	ATI518PD
MS21072-4	Single Wing	ATI518PE
NAS1067-08	Single Wing	ATI518PC
NAS1067-3	Single Wing	ATI518PD
NAS1067-4	Single Wing	ATI518PE
NAS1774-06	Single Wing	ATI518G
NAS1774-08	Single Wing	ATI518H
NAS1774-3	Single Wing	ATI518J
NAS1774-4	Single Wing	ATI518RO
NAS1774-5	Single Wing	ATI518RP

### SINGLE WING

Nutplate Spec	Style	Part Number
NAS1774-6	Single Wing	ATI518RH
NAS1792-3	Single Wing	ATI518J
NAS1792-4	Single Wing	ATI518RO
NAS1792-5	Single Wing	ATI518RP
NAS687-06	Single Wing	ATI518G
NAS687-08	Single Wing	ATI518H
NAS687-3	Single Wing	ATI518J
NAS687-4	Single Wing	ATI518RO
NAS687-5	Single Wing	ATI518RP

### DOUBLE WING

Nutplate Spec	Style	Part Number
MS21047-06	Double Wing	ATI518A
MS21047-08	Double Wing	ATI518B
MS21047-3	Double Wing	ATI518C
MS21047-4	Double Wing	ATI518D
MS21047-5	Double Wing	ATI518E
MS21047-6	Double Wing	ATI518F
MS21048-06	Double Wing	ATI518A
MS21048-08	Double Wing	ATI518B
MS21048-3	Double Wing	ATI518C
MS21048-4	Double Wing	ATI518D
MS21048-5	Double Wing	ATI518E
MS21048-6	Double Wing	ATI518F
MS21048-7	Double Wing	ATI518GP
MS21049-08	Double Wing	ATI518B
MS21049-3	Double Wing	ATI518C
MS21049-4	Double Wing	ATI518D
MS21049-5	Double Wing	ATI518E
MS21050-08	Double Wing	ATI518B
MS21050-3	Double Wing	ATI518C
MS21050-4	Double Wing	ATI518D
MS21050-5	Double Wing	ATI518E
MS21059-06	Double Wing	ATI518A
MS21059-08	Double Wing	ATI518B
MS21059-3	Double Wing	ATI518C
MS21059-4	Double Wing	ATI518D
MS21059-5	Double Wing	ATI518E
MS21059-6	Double Wing	ATI518F
MS21060-06	Double Wing	ATI518A
MS21060-08	Double Wing	ATI518B
MS21060-3	Double Wing	ATI518C
MS21060-4	Double Wing	ATI518D
MS21060-5	Double Wing	ATI518E
MS21060-6	Double Wing	ATI518F
MS21069-04	Double Wing	ATI518NA
MS21069-06	Double Wing	ATI518NB
MS21069-08	Double Wing	ATI518NC
MS21069-3	Double Wing	ATI518ND
MS21069-4	Double Wing	ATI518NE



**DOUBLE WING**

Nutplate Spec	Style	Part Number
MS21069-5	Double Wing	ATI518NASAA5
MS21069-6	Double Wing	ATI518NASAA6
MS21070-04	Double Wing	ATI518NA
MS21070-06	Double Wing	ATI518NB
MS21070-08	Double Wing	ATI518NC
MS21070-3	Double Wing	ATI518ND
MS21070-4	Double Wing	ATI518NE
MS21070-5	Double Wing	ATI518NASAA5
MS21075-04	Double Wing	ATI518NA
MS21075-06	Double Wing	ATI518NB
MS21075-08	Double Wing	ATI518NC
MS21075-3	Double Wing	ATI518ND
MS21075-4	Double Wing	ATI518NE
MS21075-5	Double Wing	ATI518NASAA5
MS21076-04	Double Wing	ATI518NA
MS21076-06	Double Wing	ATI518NB
MS21076-08	Double Wing	ATI518NC
MS21076-3	Double Wing	ATI518ND
MS21076-4	Double Wing	ATI518NE
MS21076-5	Double Wing	ATI518NASAA5
NAS1068-04	Double Wing	ATI518NASAA4
NAS1068-06	Double Wing	ATI518NSAA06
NAS1068-08	Double Wing	ATI518NC
NAS1068-3	Double Wing	ATI518ND
NAS1068-4	Double Wing	ATI518NE
NAS1068-5	Double Wing	ATI518NASAA5
NAS1473-08	Double Wing	ATI518B
NAS1473-3	Double Wing	ATI518C
NAS1473-4	Double Wing	ATI518D
NAS1473-5	Double Wing	ATI518E
NAS1474-3	Double Wing	ATI518SP1016
NAS1791-3	Double Wing	ATI518C
NAS1791-4	Double Wing	ATI518D
NAS1791-5	Double Wing	ATI518E
NAS697-02	Double Wing	AT518NASAA02
NAS697-03	Double Wing	AT518NASAA03
NAS697-04	Double Wing	ATI518NASAA4
NAS697-06	Double Wing	ATI518NSAA06
NAS697-08	Double Wing	ATI518NC
NAS697-3	Double Wing	ATI518ND
NAS697-4	Double Wing	ATI518NE
NAS697-5	Double Wing	ATI518NASAA5
NAS697-6	Double Wing	ATI518NASAA6

**CORNER**

Nutplate Spec	Style	Part Number
MS21055-06	CORNER	ATI518R
MS21055-08	CORNER	ATI518S
MS21055-3	CORNER	ATI518T
MS21055-4	CORNER	ATI518U

**CORNER**

Nutplate Spec	Style	Part Number
MS21055-5	CORNER	ATI518V
MS21055-6	CORNER	ATI518W
MS21055-7	CORNER	ATI518X
MS21056-06	CORNER	ATI518R
MS21056-08	CORNER	ATI518S
MS21056-3	CORNER	ATI518T
MS21056-4	CORNER	ATI518U
MS21056-5	CORNER	ATI518V
MS21056-6	CORNER	ATI518W
MS21056-7	CORNER	ATI518X
MS21057-08	CORNER	ATI518S
MS21057-3	CORNER	ATI518T
MS21057-4	CORNER	ATI518U
MS21057-5	CORNER	ATI518V
MS21058-08	CORNER	ATI518S
MS21058-3	CORNER	ATI518T
MS21058-4	CORNER	ATI518U
MS21058-5	CORNER	ATI518V
MS21073-02	CORNER	ATI518NSCA02
MS21073-04	CORNER	ATI518SA
MS21073-06	CORNER	ATI518SB
MS21073-08	CORNER	ATI518SC
MS21073-3	CORNER	ATI518SD
MS21073-4	CORNER	ATI518SE
MS21073-5	CORNER	AT518NASCA5
MS21074-02	CORNER	ATI518NSCA02
MS21074-04	CORNER	ATI518SA
MS21074-06	CORNER	ATI518SB
MS21074-08	CORNER	ATI518SC
MS21074-3	CORNER	ATI518SD
MS21074-4	CORNER	ATI518SE
MS21074-5	CORNER	AT518NASCA5

**SHORT LUG**

Nutplate Spec	Style	Part Number
NAS1789-08	SHORT LUG	AT518NSDA08
NAS1789-3	SHORT LUG	ATI518TA
NAS1789-4	SHORT LUG	ATI518TB
NAS1789-5	SHORT LUG	ATI518TD
NAS1789-6	SHORT LUG	AT518NASDA6



**SAFETY PRECAUTION:** Read and follow all safety and operating instructions.  
**WARNING:** Face & eye protection must be worn while operating power tools, per ANSI B186.1