

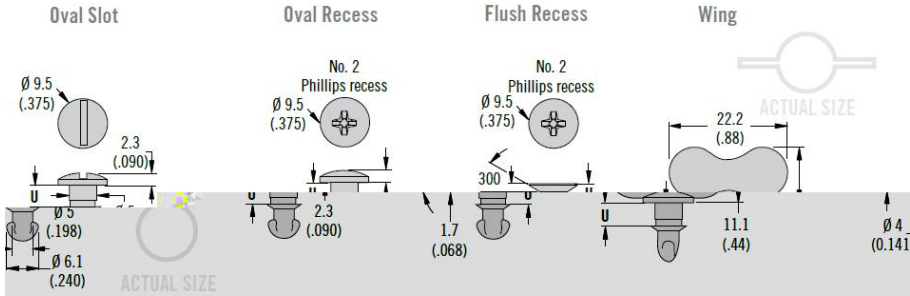

82 DZUS® Studs

H Head Styles - Tool Actuated



Panel Preparation

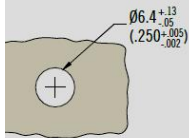

Flush Head Styles

(when outer panel is 1.3 (.050) or greater)

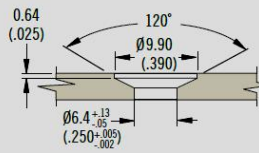

Number Selection

Head style
Oval slot
Wing head
Oval Phillips recess
Flush Phillips recess

K Length
Enter number from selection table below

82 - **H** - **K** - **M**

M Material
16 Steel, zinc plated
20 Stainless steel (not available in tool head recess head style)

Length Table					
A		D		K	U
TMT Range For: 32-35-306-10		TMT Range For: All Other Receptacles			
Min.	Max.	Min.	Max.		
.026	1.2 (.045)	2.3 (.090)	2.8 (.110)	100	3.2 (.127)
.045	1.7 (.065)	2.8 (.110)	3.3 (.130)	120	3.7 (.147)
.065	2.2 (.085)	3.3 (.130)	3.8 (.150)	140	4.2 (.167)
.085	2.7 (.105)	3.8 (.150)	4.3 (.170)	160	4.7 (.187)
.105	3.2 (.125)	4.3 (.170)	4.8 (.190)	180	5.3 (.207)
.125	3.7 (.145)	4.8 (.190)	5.3 (.210)	200	5.8 (.227)
.145	4.2 (.165)	5.3 (.210)	5.8 (.230)	220	6.3 (.247)
.165	4.7 (.185)	5.8 (.230)	6.3 (.250)	240	6.8 (.267)
.185	5.2 (.205)	6.4 (.250)	6.9 (.270)	260	7.3 (.287)
.205	5.7 (.225)	6.9 (.270)	7.4 (.290)	280	7.8 (.307)
.225	6.2 (.245)	7.4 (.290)	7.9 (.310)	300	8.3 (.327)
~	~	7.9 (.310)	8.4 (.330)	320	8.8 (.347)
~	~	8.4 (.330)	8.9 (.350)	340	9.3 (.367)
~	~	8.9 (.350)	9.4 (.370)	360	9.8 (.387)
~	~	9.4 (.370)	9.9 (.390)	380	10.3 (.407)
~	~	9.9 (.390)	10.4 (.410)	400	10.8 (.427)

Stud

Part

H Head
11 Oval
12 Wing
19 Oval
28 Flush

St

0.7
1.2
1.7
2.2
2.7
3.2
3.7
4.2
4.7
5.2
5.7